

Canon

LASER CLASS[®] 700 Series

Setup Guide

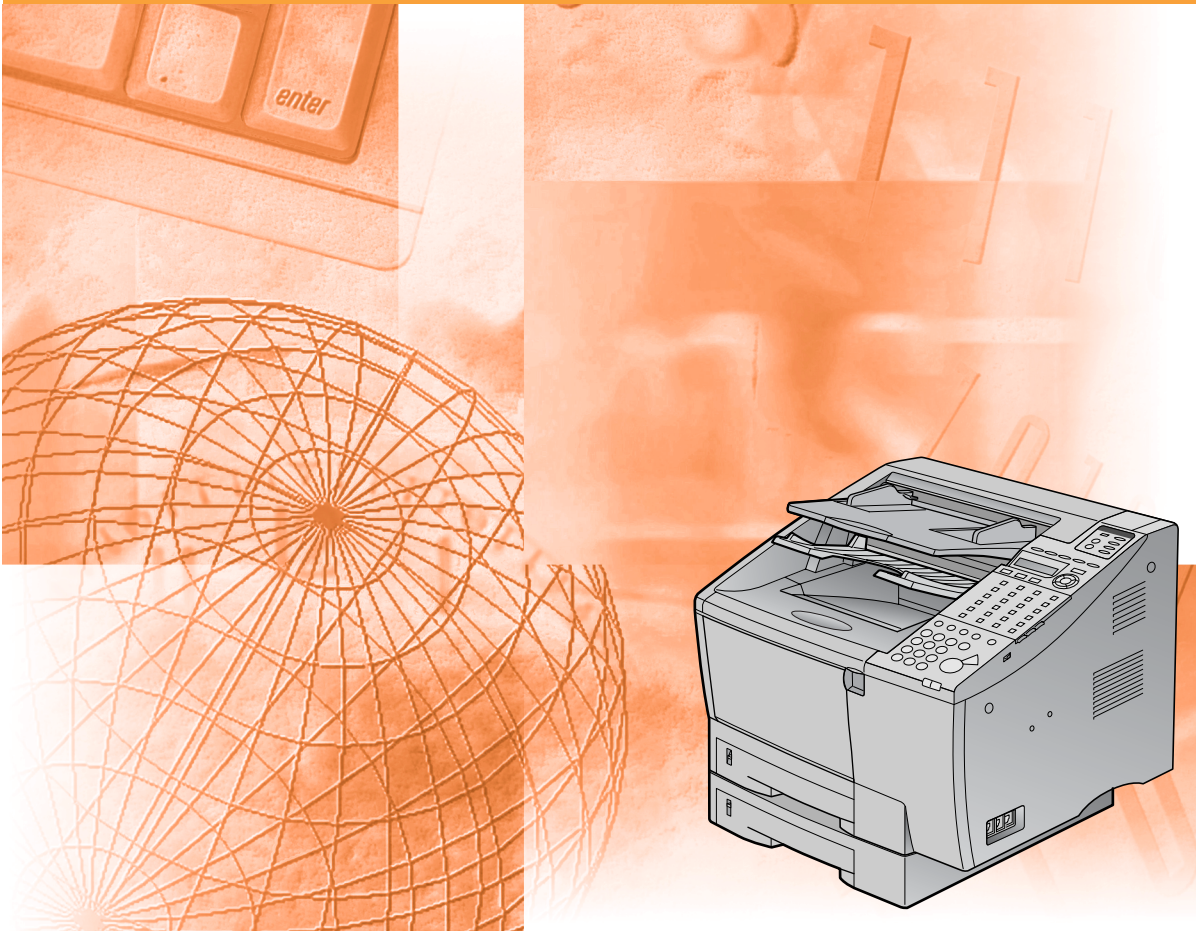

Please read this guide before operating this equipment.
After you finish reading this guide, store it in a safe place for future reference.

ENG

LASER CLASS 700 Series Setup Guide

Manuals for the Machine

The manuals for this machine are divided as follows. Please refer to them for detailed information. The manuals supplied with optional equipment are included in the list below. Depending on the system configuration and product purchased, some manuals may not be needed.



Guides with this symbol are printed manuals.



Guides with this symbol are PDF manuals included on the accompanying CD-ROM.

- **Basic Operations**
- **Troubleshooting**

Reference Guide



- **Sending Instructions**

Sending Guide



- **Fax Instructions**

Facsimile Guide



- **Setting Up the Network Connection and Installing the CD-ROM Software**

Setup Guide (This Document)



- **Remote User Interface Instructions**

Remote UI Guide



- **Network Connectivity and Setup Instructions**

Network Guide



- **PCL Printer Instructions**

PCL Printer Guide



- **PCL Printer Driver Installation and Instructions**

PCL Driver Guide



- **Fax Driver and Cover Sheet Editor Installation and Instructions**

Fax Driver Guide with Cover Sheet Editor





How This Manual Is Organized

Chapter 1 Connecting the Machine to a Network

Please read this chapter

Chapter 2 Installing Software

Contents

| | |
|--|-------------|
| Preface | vi |
| How to Use This Manual | vi |
| Symbols Used in This Manual | vi |
| Illustrations Used in This Manual | vii |
| Abbreviations Used in This Manual | vii |
| Legal Notices | viii |
| FCC (Federal Communications Commission) | viii |
| Laser Safety | viii |
| International Energy Star Program | ix |
| Trademarks | ix |
| Copyright | ix |
| Disclaimers | x |
| Legal Limitations on the Usage of Your Product and the Use of Images | x |

Chapter 1 Connecting the Machine to a Network

| | |
|--|------------|
| Setting Up the Network Connection | 1-2 |
| Settings Flowchart | 1-2 |
| Making Connections | 1-3 |
| Connecting to a Network | 1-3 |
| Connecting to a 100Base-TX Network | 1-4 |
| Connecting to a 10Base-T Network | 1-5 |

Chapter 2 Installing Software

| | |
|--|------------|
| About the User's CD-ROM Software | 2-2 |
| CD-ROM Contents | 2-2 |
| Driver Software | 2-2 |
| Network User Software | 2-3 |
| System Requirements | 2-4 |
| Installing the Software | 2-5 |
| For Windows | 2-5 |
| When the Machine Is Connected to a Network | 2-5 |
| Software Installation Instructions | 2-6 |
| Installing the PCL Printer Driver | 2-6 |
| Using the Installer | 2-6 |
| Using the Add Printer Wizard for Windows | 2-6 |
| Installing Canon Font Manager | 2-8 |
| Installing the NetSpot | 2-8 |

| | |
|---|------|
| Installing the LPR Port Utility | 2-8 |
| Installing the NetBIOS/NetBEUI Port Monitor | 2-9 |
| Installing DSE (Device Status Extension) | 2-9 |
| Installing the NDPS Gateway | 2-9 |
| Installing the Fax Driver | 2-10 |
| Using the Installer | 2-10 |
| Using the Add Printer Wizard for Windows | 2-10 |





Preface

Thank you for purchasing the Canon LASER CLASS 700 Series. Please read this manual thoroughly before operating the machine in order to familiarize yourself with its capabilities, and to make the most of its many functions. After reading this manual, store it in a safe place for future reference.

How to Use This Manual

Symbols Used in This Manual

The following symbols are used in this manual to explain procedures, restrictions, handling precautions, and instructions that should be observed for safety.

- | | |
|--|---|
|  WARNING | Indicates a warning concerning operations that may lead to death or injury to persons if not performed correctly. In order to use the machine safely, always pay attention to these warnings. |
|  CAUTION | Indicates a caution concerning operations that may lead to injury to persons, or damage to property if not performed correctly. In order to use the machine safely, always pay attention to these cautions. |
|  IMPORTANT | Indicates operational requirements and restrictions. Be sure to read these items carefully in order to operate the machine correctly, and to avoid damage to the machine. |
|  NOTE | Indicates a clarification of an operation, or contains additional explanations for a procedure. Reading these notes is highly recommended. |

Illustrations Used in This Manual

Unless otherwise mentioned, illustrations used in this manual are those taken when no optional equipment is attached to the LASER CLASS 710.

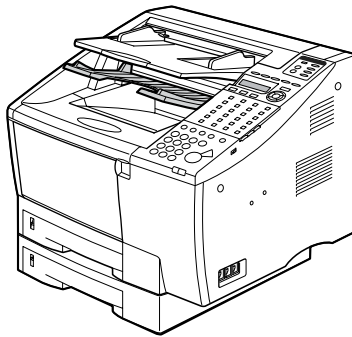

The model LASER CLASS 710 is used for illustration purposes in this manual. When there is any difference between the three models (710, 720i, or 730i), it is clearly indicated in the text, e.g., “LASER CLASS 720i only.”

Abbreviations Used in This Manual

In this manual, product names and model names are abbreviated as follows:

| | |
|--|--------------|
| Microsoft® Windows® 95 operating system: | Windows 95 |
| Microsoft® Windows® 98 operating system: | Windows 98 |
| Microsoft® Windows® Millennium Edition operating system: | Windows Me |
| Microsoft® Windows NT® operating system: | Windows NT |
| Microsoft® Windows® 2000 operating system: | Windows 2000 |
| Microsoft® Windows® XP operating system: | Windows XP |
| Microsoft® Windows® operating System: | Windows |
| Novell NetWare®: | NetWare |

Legal Notices

FCC (Federal Communications Commission)

This equipment has been tested and found to comply with the limits for a Class B digital device, pursuant to part 15 of the FCC Rules. These limits are designed to provide reasonable protection against harmful interference in a residential installation. This equipment generates, uses, and can radiate radio frequency energy and, if not installed and used in accordance with the instructions, may cause harmful interference to radio communications. However, there is no guarantee that interference will not occur in a particular installation. If this equipment does cause harmful interference to radio or television reception, which can be determined by turning the equipment off and on, the user is encouraged to try to correct the interference by one or more of the following measures:

- Reorient or relocate the receiving antenna.
- Increase the separation between the equipment and receiver.
- Connect the equipment into an outlet on a circuit different from that to which the receiver is connected.
- Consult your local authorized Canon dealer or an experienced radio/TV technician for help.

Do not make any changes or modifications to the equipment unless otherwise specified in the manual. If such changes or modifications should be made, you could be required to stop operation of the equipment.

Laser Safety

This product complies with 21 CFR Chapter 1 Subchapter J as a Class I laser product under the U.S. Department of Health and Human Services (DHHS) Radiation Performance Standard according to the Radiation Control for Health and Safety Act of 1968. Class I levels of laser radiation are not considered to be hazardous.

Since radiation emitted inside the product is completely confined within protective housings and external covers, the laser beam cannot escape from the machine during any phase of user operation. Do not remove protective housings or external covers, except as directed by the equipment's *Reference Guide*.

International Energy Star Program



As an ENERGY STAR® Partner, Canon USA, Inc. has determined that this product meets the ENERGY STAR® Program for energy efficiency.

The International ENERGY STAR® Office Equipment Program is an international program that promotes energy saving through the use of computers and other office equipment. The program backs the development and dissemination of products with functions that effectively reduce energy consumption. It is an open system in which business proprietors can participate voluntarily. The targeted products are office equipment, such as computers, displays, printers, facsimiles, and copiers. The standards and logos are uniform among participating nations.

Trademarks

Adobe and Acrobat Reader are trademarks of Adobe Systems Incorporated.

Canon, the Canon Logo, LASER CLASS, and NetSpot are trademarks of Canon Inc.

Microsoft, Windows, and Windows NT are registered trademarks of Microsoft Corporation in the United States and in other countries. Wingdings is a trademark of Microsoft Corporation.

NetWare and Novell are registered trademarks of Novell Inc.

Novell Distributed Print Service and NDPS are trademarks of Novell Inc.

PCL, PCL 5e, and PCL 6 are trademarks of Hewlett-Packard Company.

UNIX is a registered trademark exclusively licensed from X/Open Company, Ltd. in the United States and in other countries.

Other product and company names herein may be the trademarks of their respective owners.

Copyright

Copyright 2002 by Canon Inc. All rights reserved.

No part of this publication may be reproduced or transmitted in any form or by any means, electronic or mechanical, including photocopying and recording, or by any information storage or retrieval system without the prior written permission of Canon Inc.

Disclaimers

The information in this document is subject to change without notice.

CANON INC. MAKES NO WARRANTY OF ANY KIND WITH REGARD TO THIS MATERIAL, EITHER EXPRESS OR IMPLIED, EXCEPT AS PROVIDED HEREIN, INCLUDING WITHOUT LIMITATION, THEREOF, WARRANTIES AS TO MARKETABILITY, MERCHANTABILITY, FITNESS FOR A PARTICULAR PURPOSE OF USE OR AGAINST INFRINGEMENT OF ANY PATENT. CANON INC. SHALL NOT BE LIABLE FOR ANY DIRECT, INCIDENTAL, OR CONSEQUENTIAL DAMAGES OF ANY NATURE, OR LOSSES OR EXPENSES RESULTING FROM THE USE OF THIS MATERIAL.

Legal Limitations on the Usage of Your Product and the Use of Images

Using your product to scan, print, or otherwise reproduce certain documents, and the use of such images as scanned, printed, or otherwise reproduced by your product, may be prohibited by law and may result in criminal and/or civil liability. A non-exhaustive list of these documents is set forth below. This list is intended to be a guide only. If you are uncertain about the legality of using your product to scan, print, or otherwise reproduce any particular document, and/or of the use of the images scanned, printed or otherwise reproduced, you should consult in advance with your legal advisor for guidance.

- **Paper Money**
- **Money Orders**
- **Certificates of Deposit**
- **Postage Stamps (canceled or uncanceled)**
- **Identifying Badges or Insignias**
- **Selective Service or Draft Papers**
- **Checks or Drafts Issued by Governmental Agencies**
- **Motor Vehicle Licenses and Certificates of Title**
- **Travelers Checks**
- **Food Stamps**
- **Passports**
- **Immigration Papers**
- **Internal Revenue Stamps (canceled or uncanceled)**
- **Bonds or Other Certificates of Indebtedness**
- **Stock Certificates**
- **Copyrighted Works/Works of Art without Permission of Copyright Owner**

Connecting the Machine to a Network

1

CHAPTER

This chapter describes how to connect the machine to a computer or network so that you can print from the machine.

| | |
|---|-----|
| Setting Up the Network Connection | 1-2 |
| Settings Flowchart | 1-2 |
| Making Connections | 1-3 |
| Connecting to a Network | 1-3 |

Setting Up the Network Connection

This section describes how to connect the machine to a personal computer or network, and describes the types of connectors and cables you should use.

Settings Flowchart

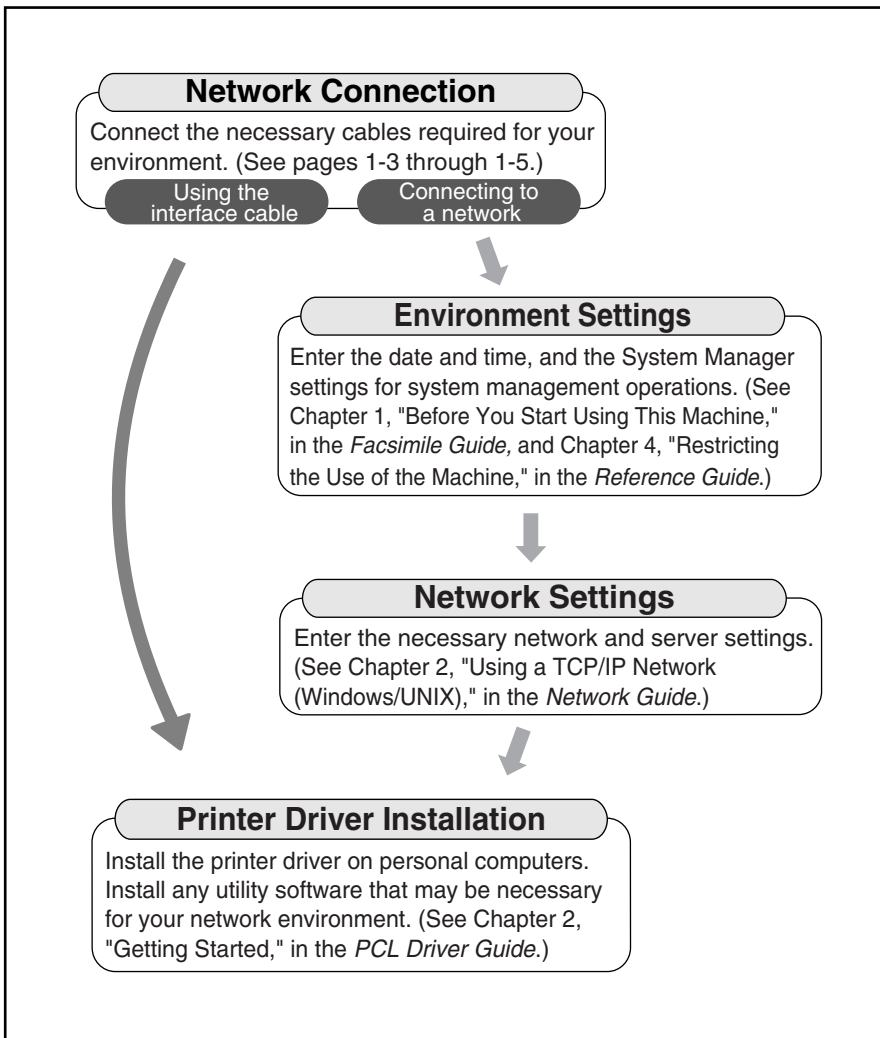

Making Connections

Connect the machine to a computer or network using an interface cable which supports bidirectional communication or a 100Base-TX or 10Base-T Ethernet cable.

WARNING

To avoid electrical shock, disconnect the power cord from the power outlet, before connecting an interface cable or network cable. (See Chapter 1, “Before You Start Using This Machine,” in the *Reference Guide*.)

NOTE

This machine is not supplied with an interface cable or a network cable. Please purchase the correct cable that is compatible with your computer or network.

Connecting to a Network

This machine has a built-in print server that is compatible with a TCP/IP network, and allows you to use the machine as a network printer for UNIX and Windows. The print server is supplied with a 100Base-TX/10Base-T port, which allows you to connect it to a LAN (Local Area Network).

The connection examples in this section show you how to connect this machine to a network, depending on the type of LAN.

IMPORTANT

In order to connect the machine to your network, you need a LAN cable and hub.

NOTE

- The print server of this machine is compatible with a NetWare network. For details, contact your local authorized Canon dealer.
- The print server of this machine automatically detects the 100Base-TX or 10Base-T interface connection.
- After connecting the network cable, perform the following procedures. For details on each procedure, refer to the corresponding manual.
 - Installing the printer driver. (See Chapter 2, “Getting Started,” in the *PCL Driver Guide*.)
 - Date/time and system management settings. (See Chapter 1, “Before You Start Using This Machine,” in the *Facsimile Guide*, and Chapter 4, “Restricting the Use of the Machine,” in the *Reference Guide*.)
 - Print server and network settings. (See Chapter 2, “Using a TCP/IP Network (Windows/UNIX),” in the *Network Guide*.)

Connecting to a 100Base-TX Network

Connect the 10Base-T/100Base-TX cable to the hub port using a Category 5 rated twisted-pair LAN cable for use on a 100Base-TX network. Then, connect the 10Base-T/100Base-TX cable to the optional network card at the back of the LASER CLASS 700 Series machine. If your computer is not compatible with a 100Base-TX network, you would also need a 100Base-TX network board.

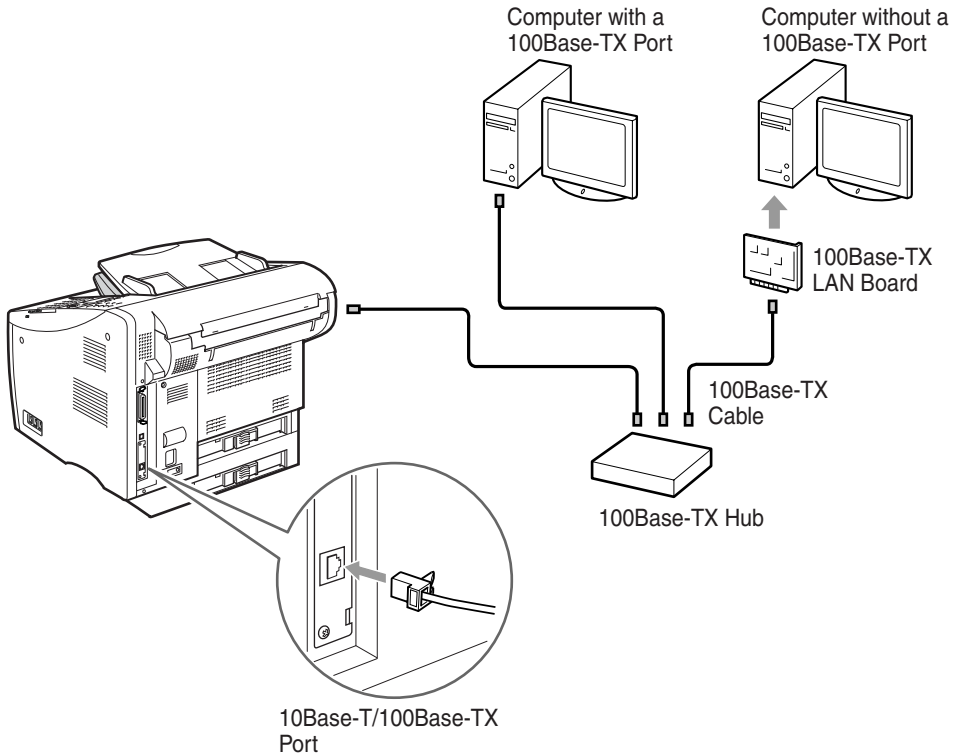

NOTE

The hub, LAN cable, and network board that is connected to the LAN, should be compatible with a 100Base-TX network. For details, contact your local authorized Canon dealer.

Connecting to a 10Base-T Network

Connect the 10Base-T/100Base-TX cable to the hub port using a Category 3 or higher rated twisted-pair LAN cable for use on a 10Base-T network. Then, connect the 10Base-T/100Base-TX cable to the optional network card at the back of the LASER CLASS 700 Series machine. If your computer is not compatible with a 10Base-T network, you would also need a 10Base-T network board.

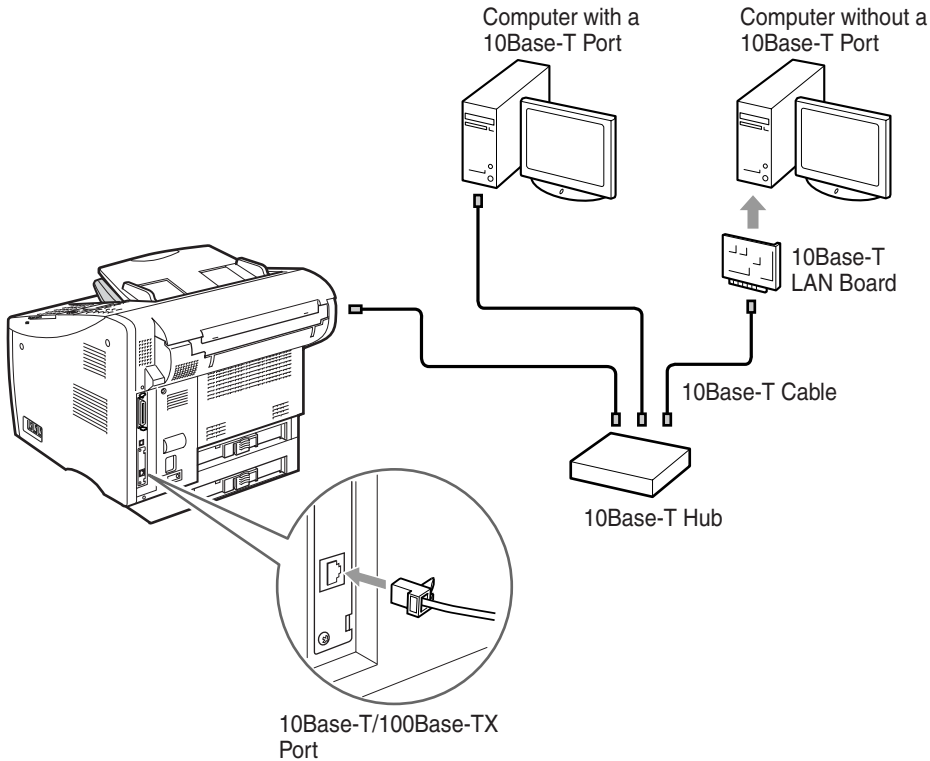

NOTE

The hub, LAN cable, and network board that is connected to the LAN, should be compatible with a 10Base-T network. For details, contact your local authorized Canon dealer.

Installing Software

2

CHAPTER

This chapter describes how to install the software on the User Software CD-ROM supplied with your machine.

| | |
|---|------------|
| About the User's CD-ROM Software | 2-2 |
| CD-ROM Contents | 2-2 |
| System Requirements | 2-4 |
| Installing the Software | 2-5 |
| For Windows | 2-5 |
| When the Machine Is Connected to a Network | 2-5 |
| Software Installation Instructions | 2-6 |
| Installing the PCL Printer Driver | 2-6 |
| Installing Canon Font Manager | 2-8 |
| Installing the NetSpot | 2-8 |
| Installing the LPR Port Utility | 2-8 |
| Installing the NetBIOS/NetBEUI Port Monitor | 2-9 |
| Installing DSE (Device Status Extension) | 2-9 |
| Installing the NDPS Gateway | 2-9 |
| Installing the Fax Driver | 2-10 |

About the User's CD-ROM Software

This section provides a list of what is on the CD-ROM, and discusses which software you should install.

CD-ROM Contents

The CD-ROM contains the following software and documentation:

Driver Software

■ **Acrobat Reader**

Install this software to view online manuals.

■ **PCL Printer Guide**

This PDF manual contains the PCL printer instructions.

■ **PCL Driver Guide**

This PDF manual contains the PCL printer driver installation and instructions.

■ **Fax Driver Guide with Cover Sheet Editor**

This PDF manual contains the fax driver and cover sheet editor installation and instructions.

■ **PCL Printer Driver**

This is essential software when you print from Windows based applications. Be sure to install this software.

■ **Fax Driver**

Install this software in order to use the facsimile function.

■ **Font Manager 2000**

Install this software to manage the 96 screen fonts which are included on the CD-ROM.

■ **Bar Code and OCR TTF**

Install these fonts in order to display them correctly.

 **NOTE**

- For the detailed installation procedures, refer to the PDF manuals and readme.txt files in each program folder on the CD-ROM.
- The PDF manuals may differ depending on which LASER CLASS 700 Series machine you have. Refer to the PDF manuals specifically for your machine.
- To access the CD-ROM menu, insert the Driver Software CD into your CD-ROM drive → double-click the [LC700.EXE].

Network User Software

■ **Acrobat Reader**

Install this software to view online manuals.

■ **Network Guide (with the optional Canon Network Kit III)**

This PDF manual contains detailed information on connecting the optional network card to your network.

■ **Remote UI Guide**

This PDF manual contains detailed information on controlling the machine via a web browser.

■ **Setup Guide**

This PDF manual (the contents are the same as this manual) contains detailed information on connecting your machine to a network and setting up the network environment.

■ **NetSpot**

NetSpot is software that enables you to display the status of any machine that is connected to a computer or network on your computer screen. This software is applicable for Windows, macintosh, and UNIX computers.

■ **LPR Port Utility**

The LPR Port Utility for Windows 95/98/Me is software that enables you to print from Windows 95/98/Me computers to printers on a TCP/IP network.

■ **NetBIOS/NetBEUI Port Monitor Utility**

The NetBIOS/NetBEUI Port Monitor Utility for Windows 95/98/Me is software that enables you to print from Windows 95/98/Me computers to printers on a NetBIOS/NetBEUI network.

■ **DSE (Device Status Extension)**

DSE is software that enables you to browse for information that is on shared printers, and enables you to manage print jobs via a web browser.

■ Canon NDPS Gateway

The Canon NDPS Gateway software configures Canon printers to operate in the Novell NetWare NDPS (Novell Distributed Print Services) architecture.

NOTE

- For the detailed installation procedures, refer to the PDF manuals and readme.txt files in each program folder on the CD-ROM.
- The PDF manuals may differ depending on which LASER CLASS 700 Series machine you have. Refer to the PDF manuals specifically for your machine.

2

System Requirements

The CD-ROM is designed for use with Windows 95/98/Me, Windows NT or Windows 2000/XP computers.

Installing the Software

Before printing, you need to install the printer drivers and utility software. When you install the software, take care to install the correct version of the software that is compatible with the operating system of your computer.



IMPORTANT

For details on the printer drivers and the installation of the software, see the *PCL Driver Guide*.

For Windows

To print from a Windows 95/98/Me/2000/XP or Windows NT computer, install the printer driver and utility software from the supplied CD-ROM.

The following software is included on the supplied CD-ROM.

■ PCL Printer Driver

This is essential software if you want to print from Windows based applications. Be sure to install this software.

■ NetSpot

This printer utility software enables you to display the status of a printer that is connected to a computer or network on your computer screen. If you set up the printer and network board, you can operate the printer from the connected computer in the same way as you would operate the printer from the operation panel. Install this software if necessary.

When the Machine Is Connected to a Network

Install the supplied “NetSpot” network administration software.



NOTE

- When this machine is connected to a network, you need to set up the network’s operating system (NetWare, UNIX, etc.), and the optional network board. For these settings, see Chapter 1, “Before You Start,” in the *Network Guide*.
- When this machine is connected to a network, print the “PRINT EN CONFIG” list from the TEST MENU to check the MAC address of the network board. Then, set up the network OS (NetWare, UNIX, etc.), and the network board. For details, see Chapter 3, “Summary of the Printer Menus,” in the *PCL Printer Guide*.

Software Installation Instructions

This section describes how to install the printer driver, fax driver, and other software included on the accompanying CD-ROM.

NOTE

- For details on installing the printer driver, see Chapter 2, “Getting Started,” in the *PCL Driver Guide*.
- For details on installing the fax driver, see Chapter 2, “Getting Started,” in the *Fax Driver Guide*.

Installing the PCL Printer Driver

IMPORTANT

For Windows NT or Windows 2000, log on to as Administrator when you install the driver.

Using the Installer

1 Insert the Driver Software CD into the CD-ROM drive.

- Double-click the [My Computer] icon on the Desktop.
- Right click the CD-ROM drive icon → click [Open] on the pop-up menu.
- Double-click the [Drivers] → [us_eng] → [prnsetup].
- Double-click the [Setup.exe] icon.

2 Follow the on screen instructions to finish installing the printer driver.

Using the Add Printer Wizard for Windows

1 On the taskbar, click [Start] → point to [Settings] → click [Printers].

- Double-click the [Add Printer] icon to start the Add Printer Wizard.
- Confirm that the Add Printer Wizard has started → click [Next].
- Click either [Local printer] or [Network printer] → click [Next].

- 2** Insert the Driver Software CD into the CD-ROM drive → click [Have Disk].
- 3** Click [Browse] → select the folder on the correct drive containing the driver you want to install → click [OK].
 - **If you want to install the PCL5e Driver**
 - From the Drives drop-down list, select the CD-ROM drive.
 - For Windows 95/98/Me, double-click [Drivers] → [us_eng] → [printer] → [pcl5e] → [win9x_me].
 - For Windows NT, double-click [Drivers] → [us_eng] → [printer] → [pcl5e] → [winnt40].
 - For Windows 2000/XP, double-click [Drivers] → [us_eng] → [printer] → [pcl5e] → [win2k_xp].
 - **If you want to install the PCL6 Driver**
 - From the Drives drop-down list, select the CD-ROM drive.
 - For Windows 95/98/Me, double-click [Drivers] → [us_eng] → [printer] → [pcl6] → [win9x_me].
 - For Windows NT, double-click [Drivers] → [us_eng] → [printer] → [pcl6] → [winnt40].
 - For Windows 2000/XP, double-click [Drivers] → [us_eng] → [printer] → [pcl6] → [win2k_xp].
- 4** If the [Install From Disk] dialog box appears, make sure that the path you selected in step 3 is showing in the [Copy manufacturer's files from] drop-down list → click [OK].
- 5** Select your printer model from the list → click [Next].
- 6** Follow the instructions on the screen to continue → click [Finish] to start copying the files.

Installing Canon Font Manager

1 Insert the Driver Software CD into the CD-ROM drive.

- Double-click the [My Computer] icon on the Desktop.
- Double-click the [Canonfm] folder → [English] folder.
- Right click the CD-ROM drive icon → click [Open] on the pop-up menu.
- Double-click the [Setup.exe] icon.

2 Follow the on screen instructions to finish installing Canon Font Manager.

Installing the NetSpot

You can install NetSpot from the Network User Software CD. For instructions on how to install NetSpot, see the *NetSpot Quick Start Guide* on the same CD.

Installing the LPR Port Utility

1 Insert the Network User Software CD into the CD-ROM drive.

- Double-click the [My Computer] icon on the Desktop.
- Right click the CD-ROM drive icon → click [Open] on the pop-up menu.
- Double-click the [Lprport] folder.
- Double-click the [Setup.exe] icon

2 Follow the on screen instructions to finish installing the LPR port utility.

Installing the NetBIOS/NetBEUI Port Monitor

1 Insert the Network User Software CD into the CD-ROM drive.

- Double-click the [My Computer] icon on the Desktop.
- Right click the CD-ROM drive icon → click [Open] on the pop-up menu.
- Double-click the [Portmon] folder.
- Double-click the [Setup.exe] icon

2 Follow the on screen instructions to finish installing the NetBIOS/NetBEUI Port Monitor.

Installing DSE (Device Status Extension)

1 Insert the Network User Software CD into the CD-ROM drive.

- Double-click the [My Computer] icon on the Desktop.
- Right click the CD-ROM drive icon → click [Open] on the pop-up menu.
- Double-click the [DSE] folder → select [Win2000] or [WinXP] → click [english] folder.
- Double-click the [Setup.exe] icon.

2 Follow the on screen instructions to finish installing DSE.

Installing the NDPS Gateway

You can install NDPS Gateway from the Network User Software CD. For instructions on how to install NDPS Gateway, see the *NDPS Gateway User's Guide* on the same CD.

Installing the Fax Driver

IMPORTANT

For Windows NT or Windows 2000, log on to as Administrator when you install the driver.

Using the Installer

1 Insert the Driver Software CD into the CD-ROM drive.

- Double-click the [My Computer] icon on the Desktop.
- Right click the CD-ROM drive icon → click [Open] on the pop-up menu.
- Double-click the [Fax_Drivers] folder → [us_eng] folder → [Faxsetup] folder.
- Double-click the [Setup.exe] icon.

2 Follow the on screen instructions to finish installing the fax driver.

Using the Add Printer Wizard for Windows

1 On the taskbar, click [Start] → point to [Settings] → click [Printers].

- Double-click the [Add Printer] icon to start the Add Printer Wizard.
- Confirm that the Add Printer Wizard has started → click [Next].
- Click either [Local printer] or [Network printer] → click [Next].

2 Insert the Driver Software CD into the CD-ROM drive → click the [Have Disk].

3 Click [Browse] → select the folder on the correct drive containing the driver you want to install → click [OK].

- From the Drives drop-down list, select the CD-ROM drive.
- For Windows 95/98/Me, double-click [Fax_Drivers] → [us_eng] → [fax] → [win9x_me].
- For Windows NT, double-click [Fax_Drivers] → [us_eng] → [fax] → [winnt40].
- For Windows 2000/XP, double-click [Fax_Drivers] → [us_eng] → [fax] → [win2k_xp].

- 4** If the [Install from Disk] dialog box appears, make sure that the path you selected in step 3 is showing in the [Copy manufacturer's files from] drop-down list → click [OK].
- 5** Select your fax model from [Printers] → click [Next].
- 6** Follow the instructions on the screen to continue → click [Finish] to start copying the files.

Canon

CANON INC.

30-2, Shimomaruko 3-chome, Ohta-ku, Tokyo 146-8501, Japan

CANON U.S.A., INC.

One Canon Plaza, Lake Success, NY 11042, U.S.A.

CANON CANADA INC.

6390 Dixie Road Mississauga, Ontario L5T 1P7, Canada

CANON EUROPA N.V.

Bovenkerkerweg 59-61 P.O. Box 2262, 1180 EG Amstelveen, The Netherlands

CANON FRANCE S.A.

17, quai du President Paul Doumer 92414 Courbevoie Cedex, France

CANON (U.K.) LTD.

Woodhatch, Reigate, Surrey, RH2 8BF, United Kingdom

CANON DEUTSCHLAND GmbH

Europark Fichtenhain A10, 47807 Krefeld, Germany

CANON ITALIA S.p.A.

Palazzo L Strada 6 20089 Milanofiori Rozzano (MI) Italy

CANON LATIN AMERICA, INC.

703 Waterford Way, Suite 400, Miami, Florida 33126, U.S.A.

CANON AUSTRALIA PTY. LTD

1 Thomas Holt Drive, North Ryde, Sydney, N.S.W. 2113, Australia

CANON SINGAPORE PTE. LTD.

79 Anson Road #09-01/06, Singapore 079906

CANON HONGKONG CO., LTD

9/F, The Hong Kong Club Building, 3A Chater Road, Central, Hong Kong

120V